

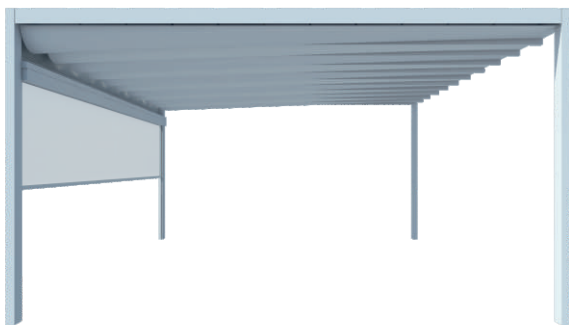

Flat

-product card

The Tarasola Flat has been created with modern architecture in mind and can be perfectly and stylishly integrated within it. The construction is made from extruded aluminium. Its retractable fabric roof visually distinguishes it through a light and simple form, which is also solid and durable at the same time. The Tarasola Flat can also come with additions such as lighting, infrared heaters and sliding glass, which allow you to use the pergola until late autumn.



SPECIFICATION

- Construction made from corrosion resistant extruded aluminium.
- Electric motor control included in the price.
- TechProtect roof fabric - comes as standard (other fabrics available on request).
- Possibility of powder coating in any RAL colour.
- Available in wall-mounted and free-standing version.
- Option of modular connection.
- Construction's wind resistance up to 120 km/h.
- Possibility of installing a fabric visor.
- Option of additional accessories:
 - lighting,
 - glazing,
 - roller blinds (screeners),
 - radiant heaters,
 - wind, solar and rain sensors.

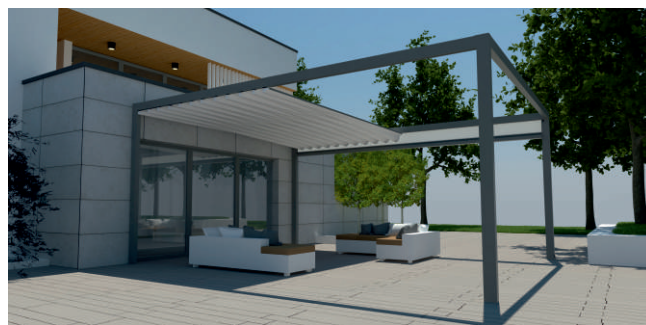

Infrared heaters



LED lighting - spotlights



LED lighting - LED strip lights, integrated with the gutter



Roller blinds (screeners)

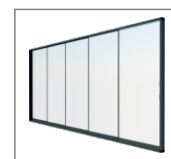

Glazing

5
YEARS
WARRANTY



120 km/h



COLOURS

CONSTRUCTION



9010ST
Colour cream-white
similar to RAL9010
(in set)



7016ST
Colour anthracite-metallic
similar to RAL 7016 (in set)



9007
Colour Grey
aluminium
RAL9007 (in set)

ADDITIONAL COLOURS



Any colour from
the RAL palette
(extra charge + 10%)



Wood-like varnish
(extra charge
+ 20%)

WIND RESISTANT BEAMS



9016
Colour White
(in set)



1013
Colour Cream
(in set)



7016ST
Colour anthracite-metallic
similar to RAL 7016 (in set)

ADDITIONAL COLOURS



Any colour from the
RAL palette
(extra charge + 5%)

FABRICS

TechProtect (in standard)

SOLTIS W 96 (extra charge)

Serge 600 SOLAR (extra charge)

STANDARD FABRIC COLOURS (TECHPROTECT)

	white/ white		bordeaux/ cream
	grey/ light grey		anthracite/ cream
	cream/ cream		taupe/ cream
	grey/ cream		green/ cream

FABRIC VISOR - option of installing a protecting cover over the rolled up fabric

GUTTERING SYSTEM - option to install a side gutter

COVER PANEL - Solid polycarbonate or aluminium panel painted in the same colour as construction

The Machinery Directive 2006/42/EC of the EU Parliament and of the Council - SAFETY OF MACHINES AND EQUIPMENT - Regulation amending Annex III to Regulation (EU) No 305/2011/ a declaration of performance on construction products (CPR), in accordance with the standards: PN - EN 13561 + A1: 2010 - EXTERNAL BLINDS - operational requirements and safety; according to the norm: PN - EN 1932: 2013 - 09 - EXTERNAL BLINDS / ROLLER SCREEN / RESISTANCE TO WIND PRESSURE - BY RESEARCH METHODS

WALL-MOUNTED MODEL PROJECTION (cm)

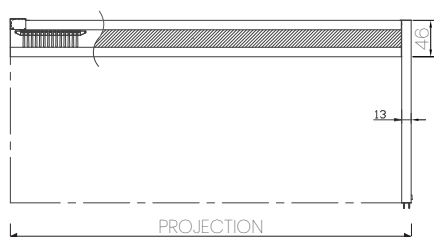

WIDTH (cm)

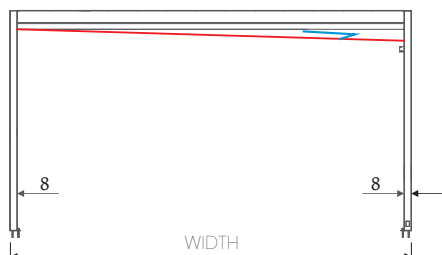

CROSS-SECTION PROFILE

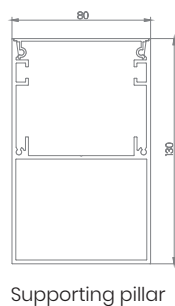

WATER DRAINAGE

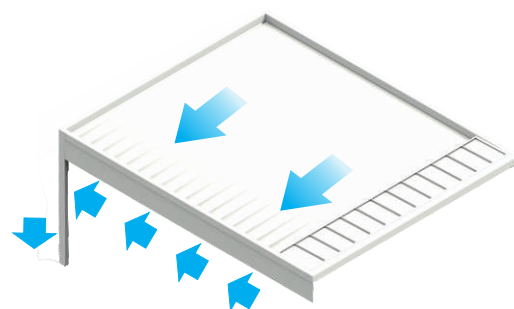

FRONT VIEW

WATER DRAINAGE

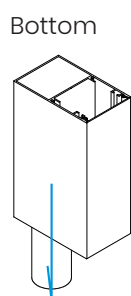
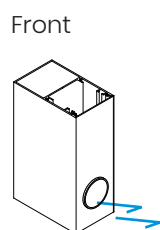

FIXING PLATE EXTERNAL

BOTTOM

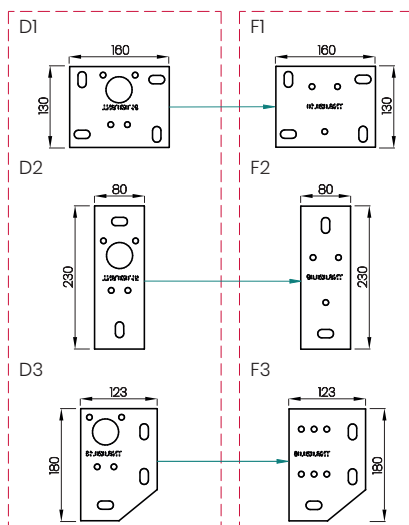

UNPAINTED STAINLESS STEEL

GUTTER CROSS-SECTION

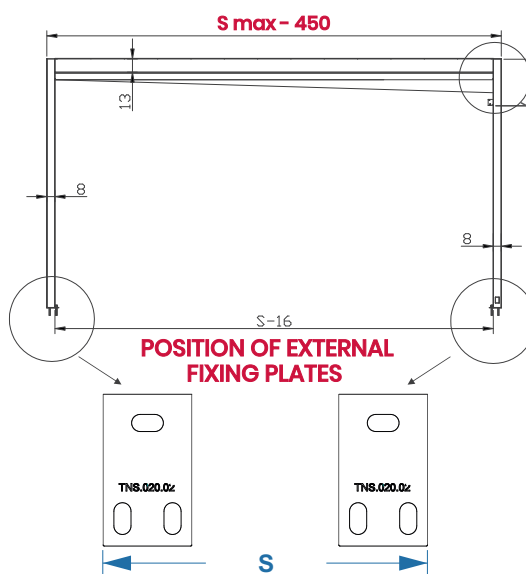
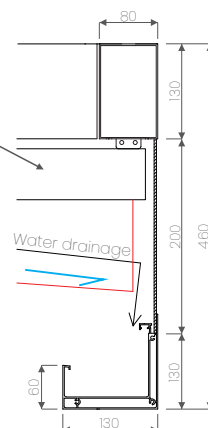

LAYOUT EXAMPLE

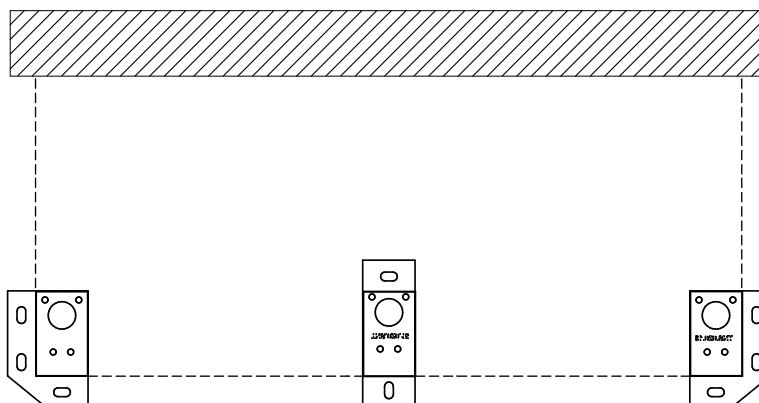

SIDE VIEW

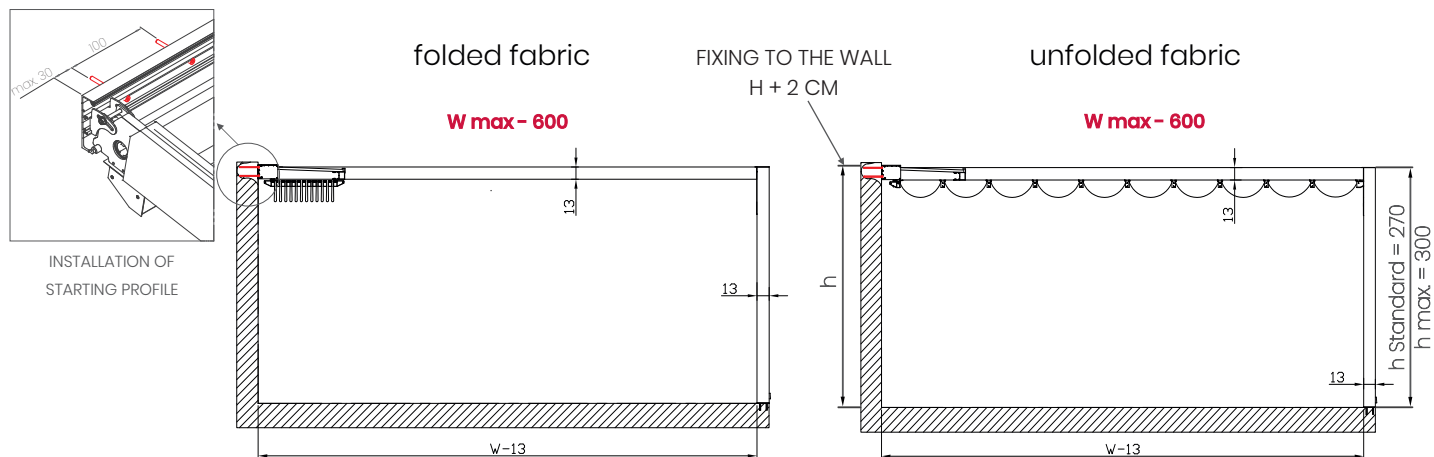

WALL-MOUNTED MODEL

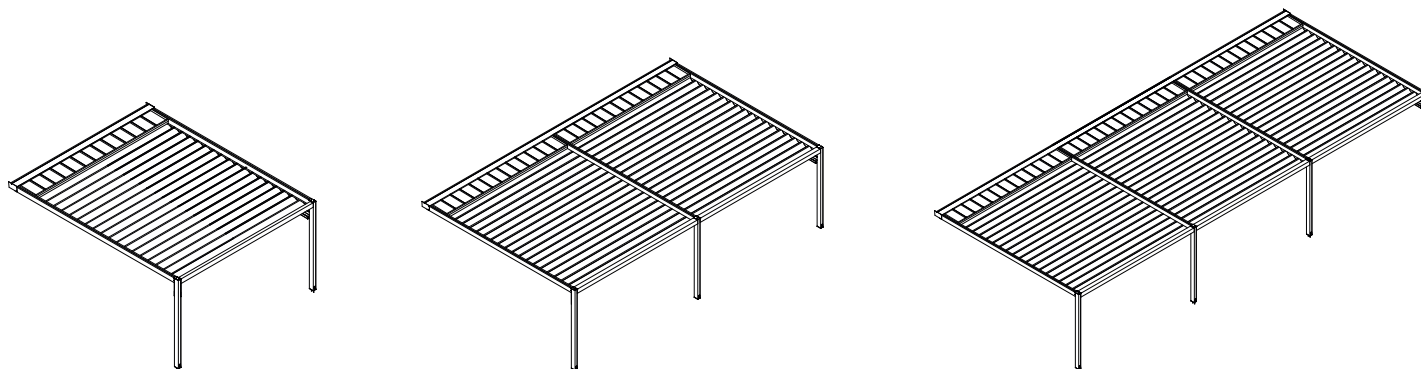

1 module:

Width max - 450 cm

Max projection - 600 cm

2 modules:

Width max - 900 cm

Max projection - 600 cm

3 modules:

Width max - 1300 cm

Max projection - 600 cm

*Runner - always in the axis of the pillar

FABRIC BUNDLE

Calculation table for the bundle and fabric visor

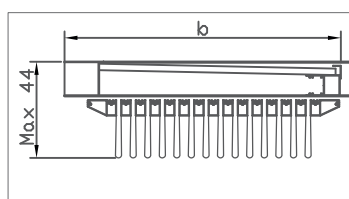

P [cm]	b[cm]	l [pc]
Projection of the construction	Projection of fabric visor	Number of wind resistant beams
200	49	5
250	55	6
300	61	7
350	67	8
400	73	9
450	79	10
500	85	11
550	91	12
600	97	13

FREE-STANDING MODEL PROJECTION (cm)

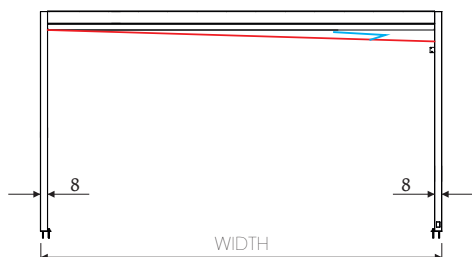
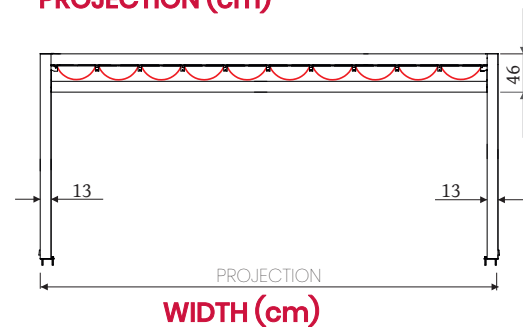

CROSS-SECTION PROFILE

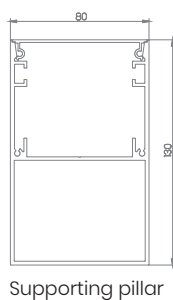

WATER DRAINAGE

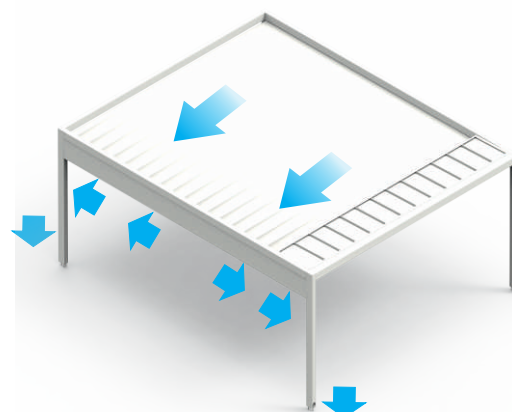

FRONT VIEW

WATER DRAINAGE

Front

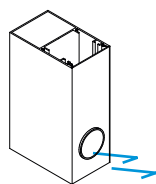

Bottom

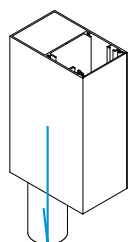

FIXING PLATE EXTERNAL

BOTTOM

FRONT

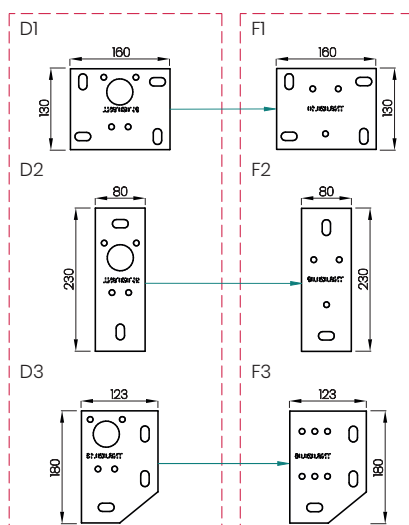

UNPAINTED STAINLESS STEEL
STANDARD IN FREE-STANDING
CONSTRUCTION

GUTTER CROSS -SECTION

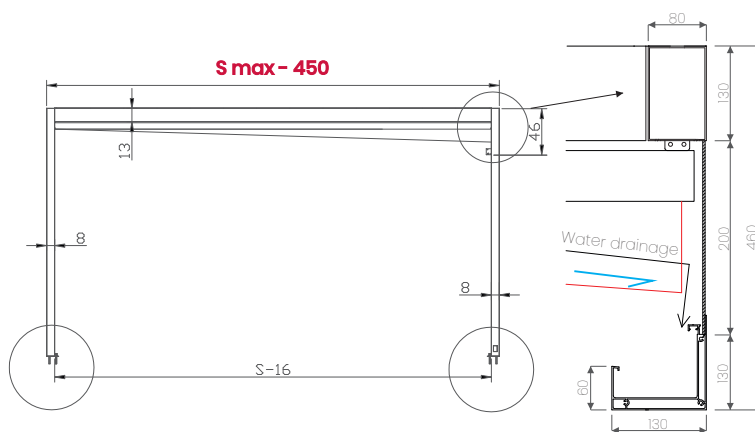

LAYOUT EXAMPLE

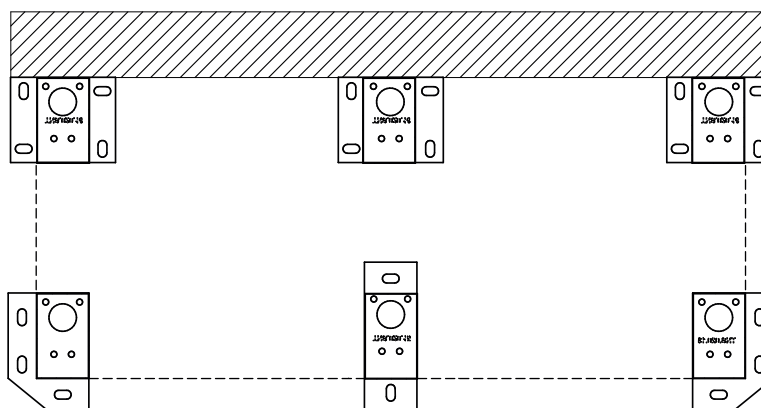

SIDE VIEW

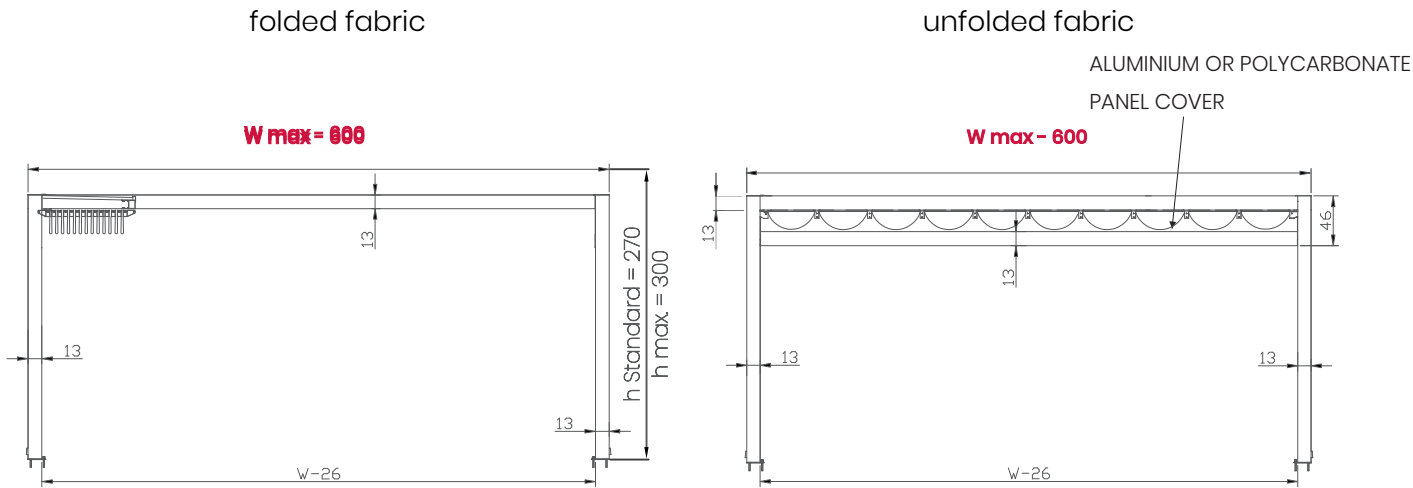

FREE-STANDING MODEL

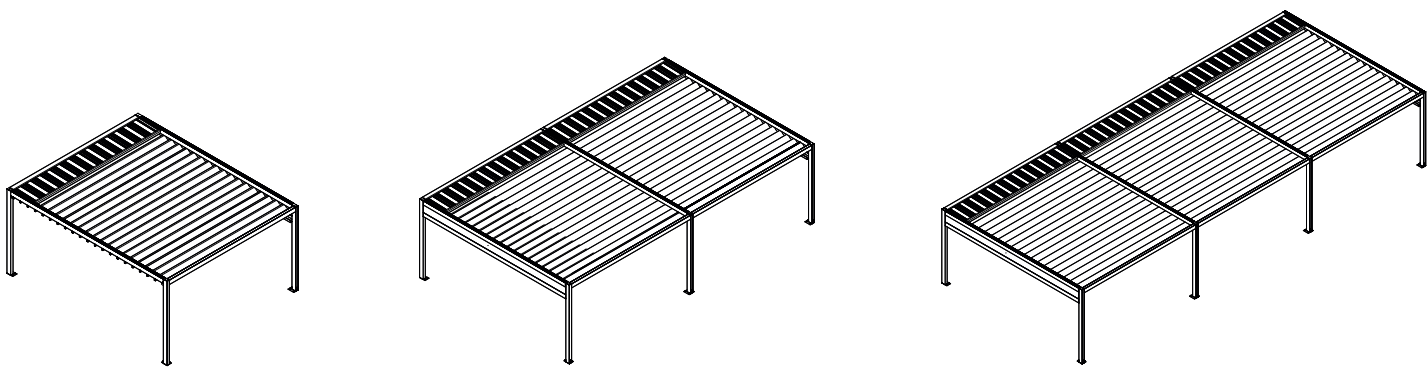

1 module:
Width max - 450 cm
Max projection - 600 cm

2 modules:
Width max - 900 cm
Max projection - 600 cm

3 modules:
Width max - 1300 cm
Max projection - 600 cm



*Rail - always in the axis of the pillar

FABRIC BUNDLE

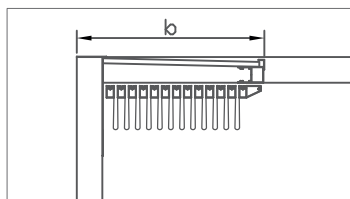
Calculation table for the bundle and fabric visor



P [cm]	b[cm]	l [pc]
Projection of the construction	Projection of fabric visor	Number of wind resistant beams
200	49	5
250	55	6
300	61	7
350	67	8
400	73	9
450	79	10
500	85	11
550	91	12
600	97	13

Fabrics		description
Techprotect		850 g/m ²
Soltis W 96		620 g/m ²
Serge 600 SOLAR		645 g/m ²
Motors		
Wired motor		
SOMFY – mechanical limit switches, compatible with TELECO control panels		
Radio motors		
SOMFY ALTUS RTS		
SOMFY PERGOLA IO		
Remote controls  RTS		
SITUO 1 RTS remote control, single-channel		
SITUO 5 RTS remote control, five-channel		
TELIS 1 SOLIRIS RTS remote control, single-channel with solar sensor support		
TELIS 4 SOLIRIS RTS remote control, five-channel with solar sensor support		
TELIS 16 RTS remote control, sixteen-channel		
Remote controls  IO		
SITUO 1 IO remote control, single-channel		
SITUO 5 IO remote control, five-channel		
NINA IO remote control		
NINA TIMER IO remote control		
Controls  TELECO		
Radio control unit for 1 motor		
Radio control unit for 1 motors, integrated with LED receiver (max. 75 pc LED spotlights)		
Power supply 150 W		
42 channel remote control, black/white		

Lighting



LED lighting - spotlights

LED spotlights

Additional control up to 25 spotlights Somfy RTS

Additional control up to 50 spotlights Somfy RTS

Additional control up to 25 spotlights Somfy IO

Additional control up to 50 spotlights Somfy IO

Min. of 8 spotlights per construction,
min. 3 LED spotlights on a wind resistant beam.



LED lighting - LED strip lights, integrated with the gutter

LED strip 8W - White

LED strip RGB 8W

Controller white/RGB TELECO
up to 28 m
(max. 4 pc LED strip)

Power supply up to 18 m

Power supply from 18-36 m

Audio System TELECO

Audio controlled via Bluetooth

Speaker 25 W

The speakers are built into the frame, diameter 10 cm. Works with the Audio Bluetooth control system.

Smartphone control

NEW

TAHOMA SOMFY

CONEXON IO

CONEXON RTS

DAISY TELECO

Weather sensors

Wind EOLIS SENSOR RTS for radio engines (white)

Wind-Solar SOLIRIS SENSOR RTS for radio engines (white)

Wind TELECO

Rain TELECO

Temperature TELECO

Rain and temperature sensors to detect snow TELECO

Infrared heaters

power

Infrared heater GR1 - controlled by a switch with a LOW GLARE emitter that generates less light, water-tight class IP65, colour: white or black, usually controlled by a wall switch. For external use.

1,5 kW

Infrared heater GR2 IR - a infrared heater with a built-in infrared receiver, remote control and a LOW GLARE emitter that releases less light. Water-tight class IP65, colour white or black, controlled by an infrared remote control (in set). For external use.

1,5 kW

Infrared heater Gr1 + receiver Somfy RTS 2 kW

Infrared heater Gr1 + receiver Somfy IO 2 kW

Additional infrared remote control

Radio receivers for infrared heaters GR1

Somfy RTS receiver

Enables to operation of the infrared heater by remote control in range of on/off. Works with TELIS remote control.

For the single infrared heater max. power 2 kW

Somfy RTS MODULIS Receiver

Enables to operation of the infrared heater by remote control in range of on/off and regulate the intensity of heat in range from 0% to 100%. Works with remote control TELIS MODULIS (recommended) and TELIS remote control.

For of 1 to 2 infrared heaters of total power 3 kW

TELECO ON/OFF Receiver up to 1-2 pcs infrared heater 3kW

For of 1 to 2 infrared heaters of total power 3 kW

SOMFY IO ON/OFF Receiver for 1 infrared heater 2kW

For the single infrared heater max. power 2 kW



Contact:

phone: +48 607 189 400

+48 502 342 842

e-mail: export@tarasola.com

www.tarasola.com